

Be sure to read this entire instruction manual before using this product.
Always keep the instruction manual with the product.



FORE WINDS
SAVOR YOUR ADVENTURE

Instruction Manual

FORE WINDS Folding Camp Stove

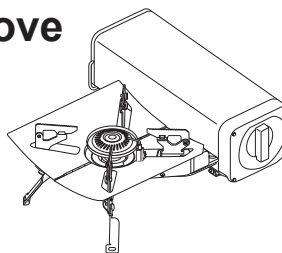

Listed by CSA



Model: FW-FS01

This appliance is for use as an outdoor only camp cooking appliance.

ANSI Z21.72-CSA 11.2-2019 Camp Stove

 DANGER	<p>CARBON MONOXIDE HAZARD</p> <p>This appliance can produce carbon monoxide which has no odor. Using it in an enclosed space can kill you. Never use this appliance in an enclosed space such as a camper, tent, car or home.</p>								
 Warning	<p>Improper installation, adjustment, alteration, service or maintenance can cause injury or death. Read the installation, operating and maintenance instructions thoroughly before installing, operating or servicing this equipment.</p>								
<p style="text-align: center;"> WARNING</p> <p>FIRE OR EXPLOSION HAZARD If you smell gas:</p> <table border="0"><tr><td>1. Do not attempt to light appliance.</td><td>5. Leave the area immediately.</td></tr><tr><td>2. Make sure appliance is in the off position.</td><td>6. Allow gas to dissipate 5 minutes.</td></tr><tr><td>3. Extinguish any nearby flame(s).</td><td>7. If gas smell has dissipated from the area, of the appliance, and fuel supply, follow gas connection procedures.</td></tr><tr><td>4. Shut off cylinder fuel supply valve if so equipped, or if equipped with a disposable fuel cylinder, disconnect cylinder.</td><td>8. If you smell gas again, follow steps 1-6 and have appliance serviced.</td></tr></table> <p>Failure to follow these instructions could result in fire or explosion, which could cause property damage, personal injury, or death.</p>		1. Do not attempt to light appliance.	5. Leave the area immediately.	2. Make sure appliance is in the off position.	6. Allow gas to dissipate 5 minutes.	3. Extinguish any nearby flame(s).	7. If gas smell has dissipated from the area, of the appliance, and fuel supply, follow gas connection procedures.	4. Shut off cylinder fuel supply valve if so equipped, or if equipped with a disposable fuel cylinder, disconnect cylinder.	8. If you smell gas again, follow steps 1-6 and have appliance serviced.
1. Do not attempt to light appliance.	5. Leave the area immediately.								
2. Make sure appliance is in the off position.	6. Allow gas to dissipate 5 minutes.								
3. Extinguish any nearby flame(s).	7. If gas smell has dissipated from the area, of the appliance, and fuel supply, follow gas connection procedures.								
4. Shut off cylinder fuel supply valve if so equipped, or if equipped with a disposable fuel cylinder, disconnect cylinder.	8. If you smell gas again, follow steps 1-6 and have appliance serviced.								
<p style="text-align: center;">FOR YOUR SAFETY</p>									
<p>Do not store or use gasoline or other liquids with flammable vapours in the vicinity of this or any other appliance.</p>									
<p> WARNING : This product and all products that burn gas can expose you to Carbon Monoxide which is known to the State of California to cause birth defect or other reproductive harm. Always use in well ventilated areas. For more information go to www.P65Warnings.ca.gov.</p>									
<p> WARNING : This appliance must NEVER be used without the drip pan and grate provided with this appliance installed in their proper position. Attempting to cook without these parts in place may cause overheating of the fuel canister, resulting in a fire or explosion.</p>									



Table of contents

Names and uses of parts	3
• Specifications	3
• Assembly method	4
• Ignition, adjusting the heating power, and extinguishing the flame	6
• Storage method	7
Usage precautions	8
• Handling the Canister	10
Maintenance and inspection after use	11
Warranty and Repair	11
Troubleshooting	12

Be sure to read this Instruction Manual before use.

<Before use>

In order to ensure safe and correct usage of this product as well as to prevent injury or physical damage to you and others, there are many symbols in the instruction manual to explain the product. The symbols and their meanings are explained below. Please ensure you have carefully read and understand the content before reading the main text.

 Danger	This symbol indicates matters that may lead to death, serious injury or fire if ignored or incorrectly handled.
 Warning	This symbol indicates matters that may lead to imminent risk of death or serious injury if ignored or incorrectly handled.
 Caution	This symbol is displayed along with instructions that, if ignored, and if the device is inappropriately used, may lead to the user suffering an injury or material damage.

<These symbols have the following meanings>



Names and uses of parts

(In use)

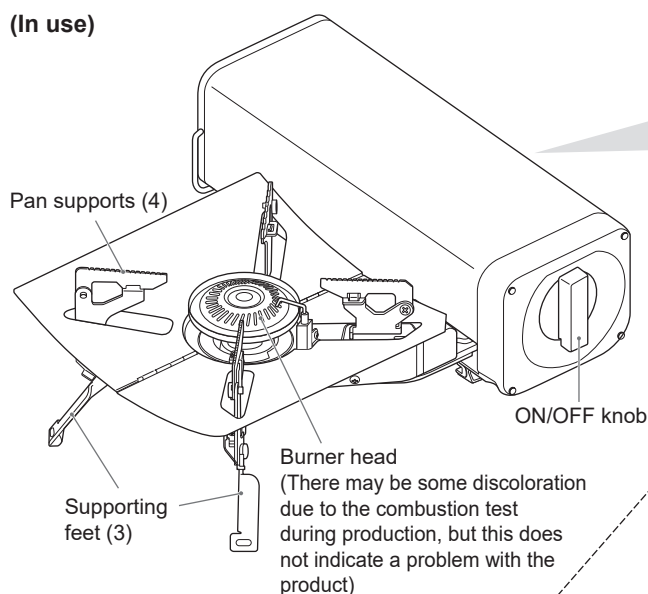

Case unit (In storage)

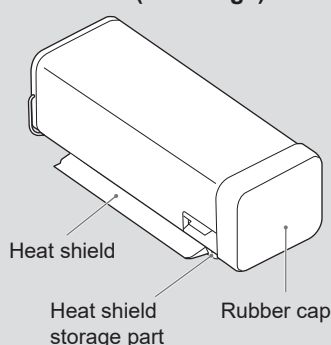

Canister

Use the following dedicated canister with this product.

Canister cap

Canister notch



Item labeled as "Iwatani Butane Fuel" or "FORE WINDS Butane Fuel"

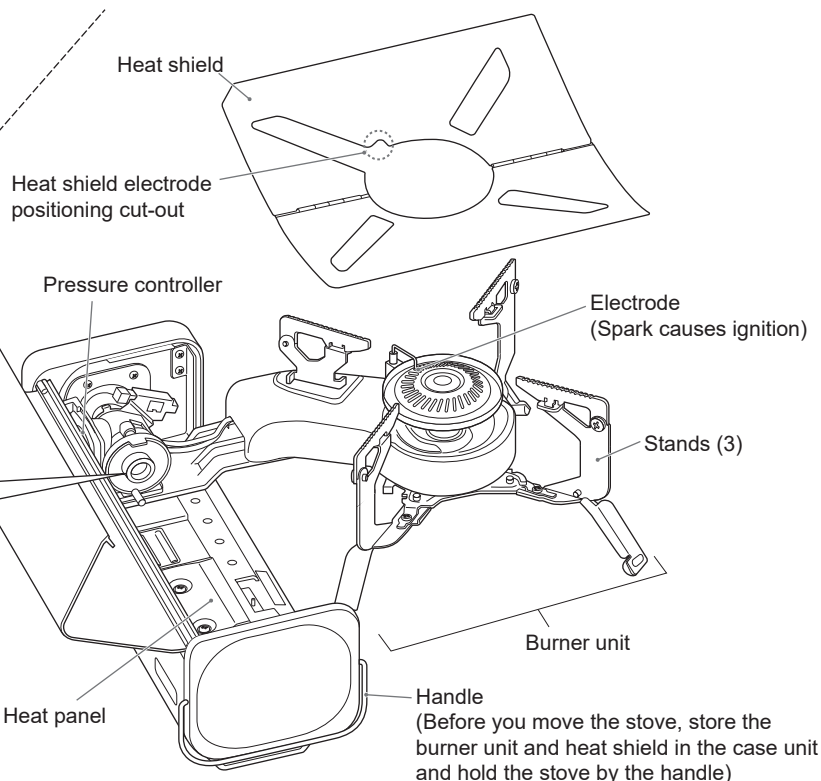

Features of this product

Heat panel to accelerate the vaporization of gas

As the vaporization of gas progresses during combustion, the temperature drops, the heating power weakens, and it becomes impossible to use all the gas in the canister.

To prevent this, a moderate amount of heat from the flame of the burner during combustion is transferred to the canister to accelerate the vaporization of gas, which maintains the heating power so that all the gas can be used up. This makes the canister slightly warm, but this is not a problem.

Detachable canister with magnet

The canister is installed using the magnet instead of a lever. This makes it difficult to install an incorrect or faulty canister.

Pressure sensor safety device

If the pressure (temperature) inside the canister becomes abnormally high (about 104°F/40°C or higher), the canister is detached automatically, and the flame is extinguished.

●When the pressure sensor safety device has been activated, return the ON/OFF knob to the "OFF" position, and then remove the canister from the main unit. Next, carefully read "Usage precautions" (from page 8 through 10) and remove the cause of the problem. Next, either reinstall the canister after it is been cooled by water or install a new canister before using the product again.

Specifications

Product name	FORE WINDS Folding Camp Stove
Model number	FW-FS01
Ignition type	Piezoelectric
Safety features	Pressure sensor safety device (Detachable canister model) Canister installation safety device
Maximum external dimensions	(In use) 12.5"/317 mm (W) × 11.3"/288 mm (D) × 4.7"/120 mm (H) (In storage) 4.4"/111 mm (W) × 11.2"/285 mm (D) × 4.5"/114 mm (H)
Unit weight	Approx. 3.5 lbs/1.6 kg (canister not included)

Output (gas consumption)	7,800 BTU/hr (2.3 kW) (at an air temperature of 68-77°F/20-25°C)
Continuous combustion	Approx. 120 minutes (Actual value when completely using a new canister at maximum power. Air temperature of 68-77°F/ 20-25°C.)
Canister	Dedicated canister labeled as "Iwatani Butane Fuel" or "FORE WINDS Butane Fuel"
Pot available to use	Diameter of bottom of pot should be less than 9.5"/24 cm. Weight capacity up to 11 lbs/5 kg including food and cooking vessel.

■ Assembly method

- ❶ Remove the rubber cap and heat shield from the case unit.

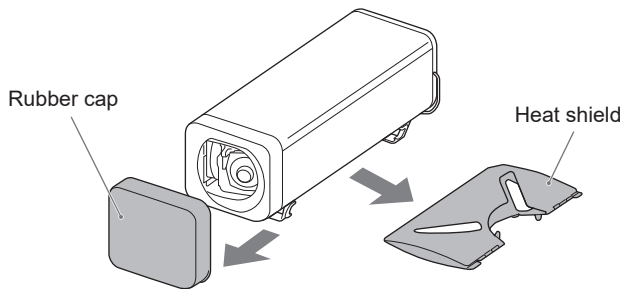

- ❷ Open the canister cover, pull out the burner unit, and open the stands (3) until they are locked.

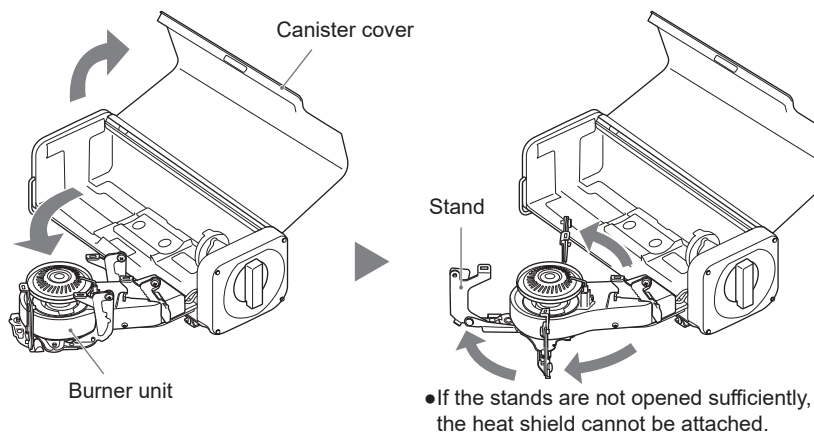

- ❸ Lower the supporting feet (3), and then set the pan supports (4) on the pan support stoppers.

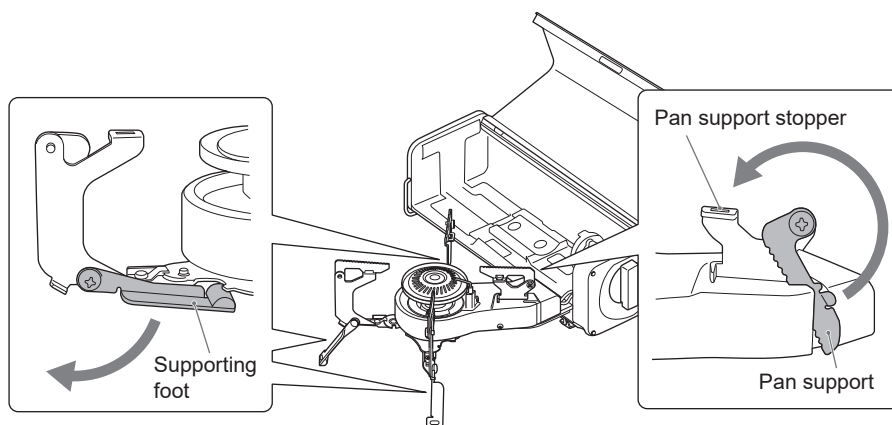

- ❹ With the heat shield open, attach it to the burner unit, and then close the canister cover.

Always attach the heat shield before use.

If the stove is used with the heat shield removed, the surface of the installation location may be burned.

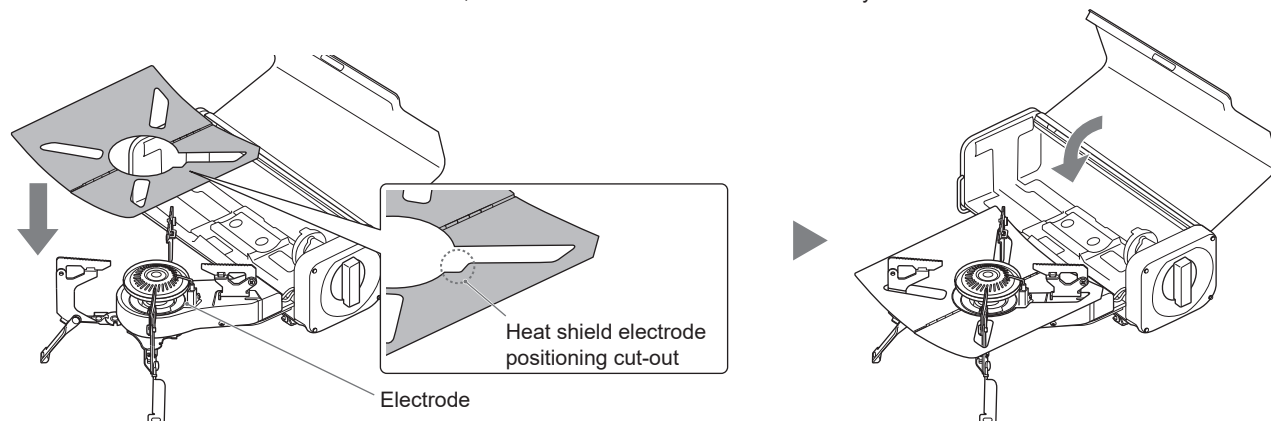

⚠ Warning



Pull out the burner unit sufficiently

If the burner unit is not pulled out sufficiently, the canister cannot be installed securely. Gas may leak from the junction of the canister during use and cause fires or burns.

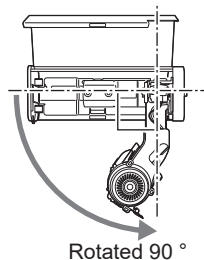

Rotated 90°

⚠ Warning



Set the pan supports securely on the pan support stoppers

If the pan supports are not opened sufficiently, the pot may become unstable and fall.



Lower the supporting feet securely

It is dangerous if they are not lowered securely. The stove may tilt, and the flame may become larger. Make sure each supporting foot is facing downwards.

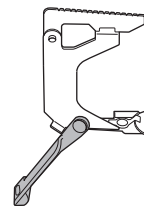

Always use a fuel canister labeled as "Iwatani Butane Fuel" or "FORE WINDS Butane Fuel"

■ Installing canister

Install a canister following the procedure below.

Be aware that if a canister is installed incorrectly, unexpected dangers may result.

- Make sure the heat shield has been attached normally.
- If the air temperature is low, or the product is used continuously, we recommend using "Iwatani Butane Fuel" or "FORE WINDS Butane Fuel".

① Open the canister cover.

② Turn the ON/OFF knob in the "OFF" direction until it stops.

- If the ON/OFF knob is not in the "OFF" position, the canister installation safety device is activated, and the canister cannot be installed.

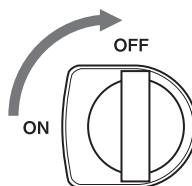

③ Make sure no foreign objects have adhered to the magnet.

■ When foreign objects have adhered to the magnet

If iron scraps or powder have stuck to the magnet, a gas leak may occur or it may not be possible to install the canister. If foreign objects have stuck to the magnet, use adhesive tape to remove them.

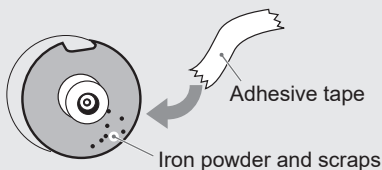

④ Remove the canister cap of the canister.

⑤ Place the canister on the heat panel and align the canister notch with the protrusion of container-receiving guide.

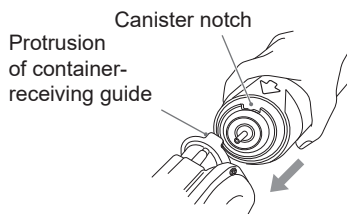

When it is difficult to install the canister (because force is required), apply a thin coat of vegetable oil to the tip of the canister (Part A in the illustration to the right).

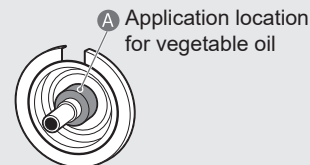

⑥ As shown in the illustration to the right, place your hand near the top of the canister, slide the canister horizontally, and push it until it fits completely with the magnet.

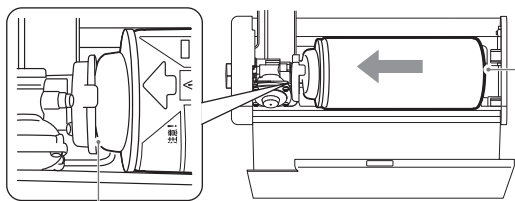

When using "Iwatani Butane Fuel"

When the canister has been installed correctly, there is a gap of about $\times \times$ "/2.5 cm at the back end of the canister. The canister installation section is designed to move with some "play". This gap does not indicate a problem, so please use this product with peace of mind.

Install the canister securely so that there is no gap between the magnet and canister.

⑦ After the canister has been installed, close the canister cover.

■ When cookware is on the stove

As shown in the illustration below, do not set a pot handle over the case unit.

<Pot with two handles>

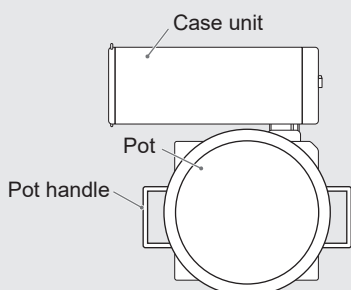

<Pot with one handle/frying pan>

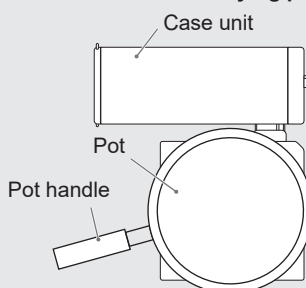

■ Ignition, adjusting the heating power, and extinguishing the flame

❶ Ignition

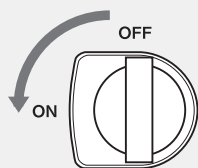

Turn the ON/OFF knob in the "ON" direction until it clicks. Make sure the flame was lit.

- If there is no flame, return the ON/OFF knob to the "OFF" position, and then try again. It may be difficult to light the product upon first use or when the temperature of the canister is low. With caution, repeat the ignition operation several times.
- If an ignition operation is performed too quickly, the gas may not spread sufficiently within the burner, which makes ignition more difficult.

❷ Adjusting the heating power

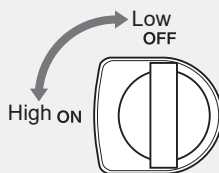

Turning the ON/OFF knob in the "ON" direction increases the heating power, while turning in the "OFF" direction decreases it.

- When using low heat, always check the flame as it is difficult to see.
- Be aware that if the flame is lowered too much, it is more likely to be extinguished by wind.

❸ Extinguishing

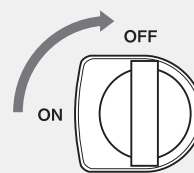

Turn the ON/OFF knob in the "OFF" direction until it stops.

■ After use (steps after extinguishing the flame)

❶ Make sure the flame is out completely

- Just after the flame is extinguished, both the main unit and the canister will be hot. Wait until they cool down.

❷ Remove the canister (below)

- Always remove the canister. Otherwise, appliance failures or gas leaks may occur.

❸ Ignite a flame after the canister has been removed

- A small amount of gas remains in the piping of the main unit. To prevent danger, perform ignition one time to burn off the remaining gas.

Advice

When ignition is difficult, light a firing rod (gas lighter, etc.), and then ignite the burner head while turning the ON/OFF knob in the "ON" direction.

- It may not be possible to light the ignition device depending on the weather or elevation. Please prepare a firing rod (gas lighter) or other similar equipment as a backup ignition source.

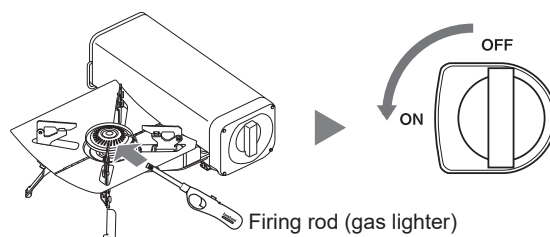

■ Removing the canister after use

After use, always remove the canister, put on the canister cap, and then store the canister.

❶ Open the canister cover.

While holding the canister, apply a small amount of force in the direction opposite the installation direction to remove it from the magnet.

❷ Put the canister cap on the removed canister.

❸ Close the canister cover.

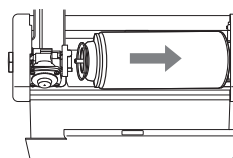

■ Storage method

After use, the equipment will be hot. Wait for the equipment to cool sufficiently before storing it. To store the burner unit correctly, the pan supports, supporting feet, and stands must be folded to their storage positions. In addition, take care because they can scratch the interior of the case unit.

- ❶ Remove the heat shield, and then open the canister cover.

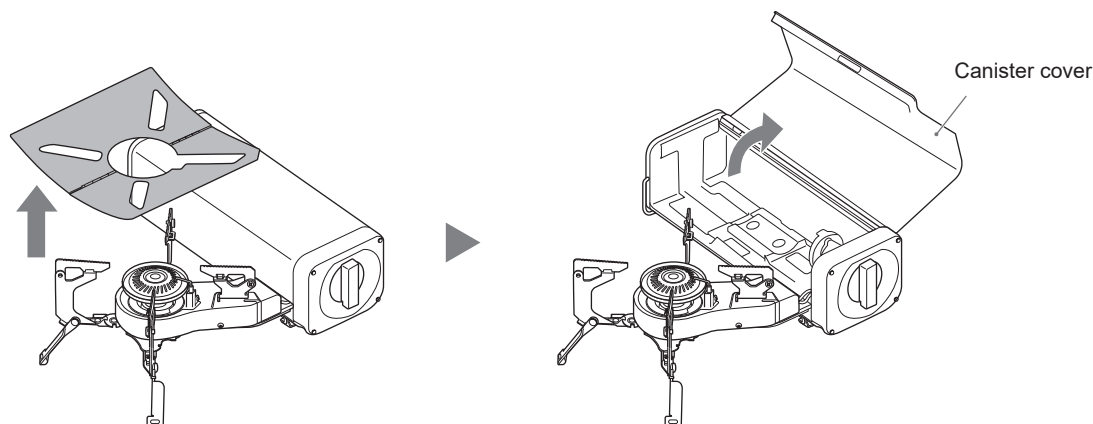

- ❷ Fold the pan supports (4) and supporting feet (3) to their storage positions.

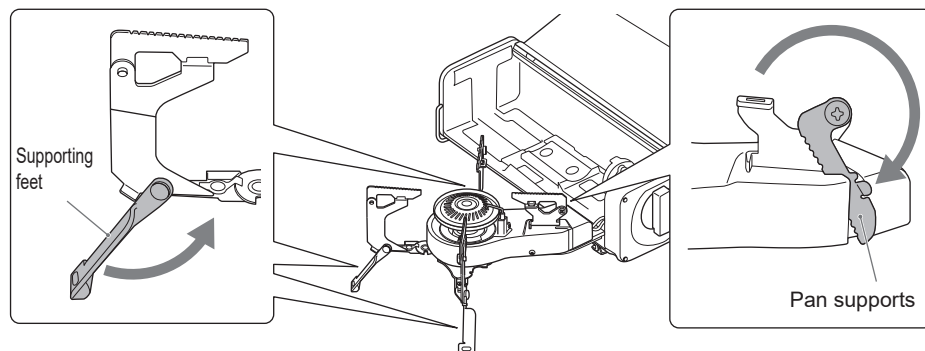

- ❸ Fold the stands (3), store the burner unit in the case unit, and then close the canister cover.

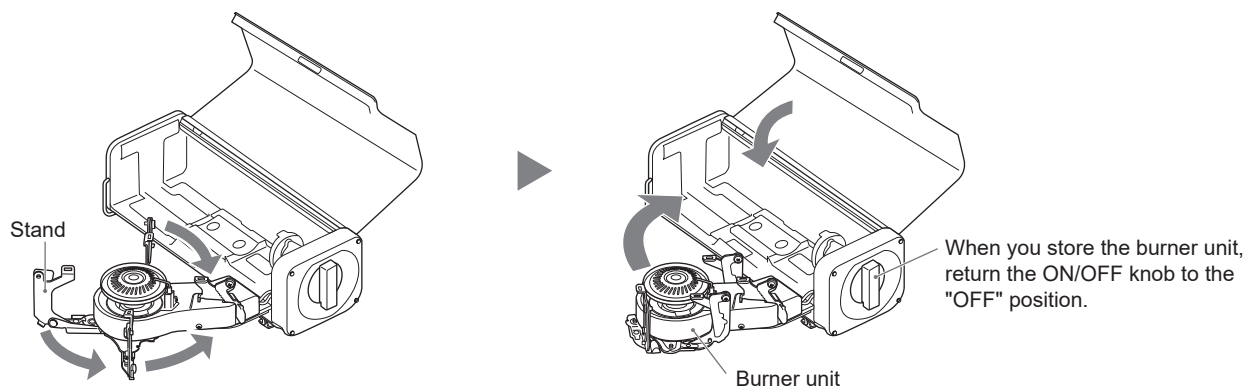

- ❹ Before storage, fold the heat shield, store it in the heat shield storage part, and then attach the rubber cap.

Insert the heat shield into the cut-out sections.

- Insert the heat shield until it is secured in the heat shield storage part. Otherwise, the heat shield may fall.

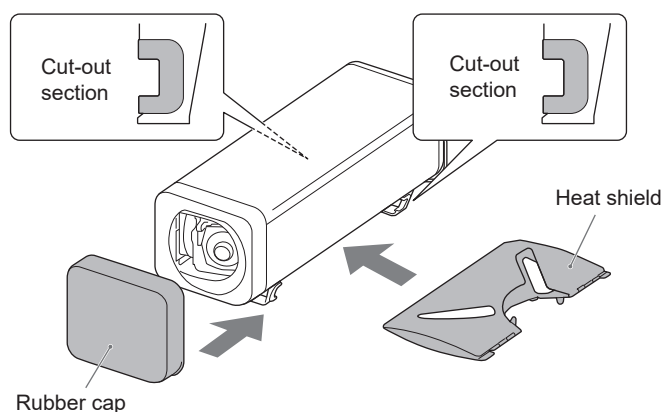

Usage precautions

Danger



If you notice a gas leak, extinguish the flame immediately

(Ignition may cause an explosion)

- If gas leaks, a gas odor (like a rotten onion) will be emitted. Butane gas is heavier than air and collects at the bottom. Perform the following steps immediately. Do not use fire while gas is leaking.

- ① Extinguish the flame immediately. (Set the ON/OFF knob to the "OFF" position)
- ② Remove the canister.

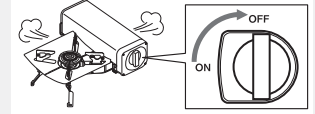

■ Usage location and circumstances

Warning



Never use this product in the following locations

(Otherwise, fires, explosions, fatal accidents, and burns will occur)

- Do not use this product in cramped places or poorly ventilated places



Never use this product inside a tent or a vehicle. During use, a large amount of oxygen is consumed, which may cause death by suffocation due to a lack of oxygen and carbon monoxide poisoning. Also, nearby combustibles may ignite and start a fire.

- Do not use this product in a vehicle or in unstable locations

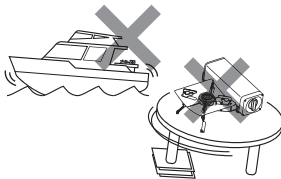

If the main unit is tilted or moved during use, the flame may become larger and cause injury or fire. There is also danger of the main unit tipping over. Use the product in stable flat locations so it does not shake, tip, or move.

- Do not use this product in strong wind

If this product is used in strong wind, the flame of the burner may be drawn into the main unit, which may cause an accident or damage to the main unit.

- Do not use this product in a location in which the canister will become overheated

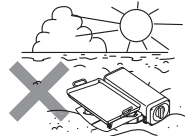

Do not use this product in a location in which the canister will become overheated by sunlight, such as on sandy beach or asphalt in the summer.

- Do not use this product near fire or heat

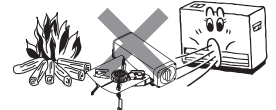

Keep the product 6 ft/2 m or more away from fire.

- Do not use the product near canisters, hairspray, and other combustibles, or cloth, paper, or other items that are easily burned

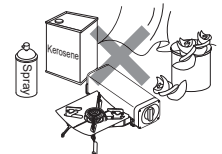

Caution



Do not use the product in a location that applies radiant heat or physical effects on the canister or stove, such as by sand or pebbles or grass or plant stubble under the main unit

(Heat radiation will worsen, the main unit will burn out, and the canister will overheat, which may cause an explosion)

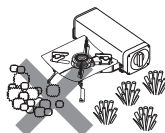

Do not use the product on a rug, tablecloth, or other heat-sensitive material

(This may cause deformation or discoloration)



Do not use the product in the location in which air or smoke is sucked up from the base of the main unit (such as a table with a smokeless roaster)

(This may cause abnormal combustion)



Do not use the product in a location in which there is danger of falling objects
(You may be burned by fire or falling cookware)



To prevent accidents, install the product with the necessary space

During use, keep the product 6"/15.25 cm or more from furniture, walls (in a wooden building), and other combustibles. Allow 40"/100 cm or more above this product from ceilings, shelves, electric appliances, and other combustibles.

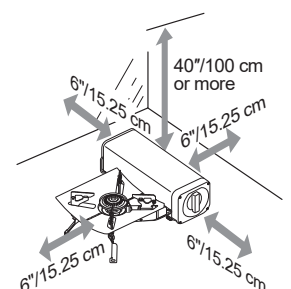

■ Before use

⚠ Warning



Do not insert objects (such as pebbles or bundles of cardboard) between the bottom of the canister and the main unit

(The pressure sensor safety device will no longer activate, which may cause the canister to explode)

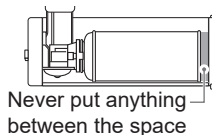

Always make sure there are no gas leaks or other problems with ignition or extinguishing operations before use

Never use a product that you believe has failed or been damaged.



Install the canister securely

(Otherwise, gas may leak and cause a fire)

⚠ Caution



- **Do not use the product on a carpet or other heat-sensitive materials**
- **Do not install items that obstruct air flow**



When you use this product on a heat sensitive table, check the heat resistance temperature and handling cautions of the table and determine whether usage is advisable

(During use, the bottom of the main unit becomes very hot, and the table may be cracked, deformed, damaged, or burned)

■ During and after use

⚠ Warning



Never use this product in the following ways

(The interior of the main unit or canister will overheat, which may cause an explosion)

- **Do not heat empty cookware**



- **Do not use two or more units of this product side-by-side**

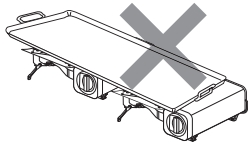

- **Do not use or store this product on another source of heat (electric cooking stove, induction cooker, etc.)**

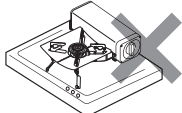

- **Do not use this product to burn charcoal or for other similar uses**

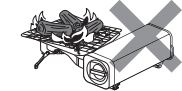

- **Do not use the product with the heat shield removed (Doing so may cause the canister to overheat and explode)**

- **Do not use large cookware (such as an iron plate) that erroneously covers the canister cover**
When you use a small cooking vessel, make sure that it is placed on the stove stably. Unstable cooking vessels may tip over.

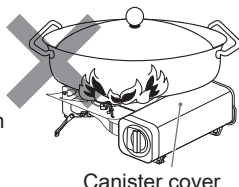

Canister cover

- **Do not use utensils made of stone, sand, or ceramic that cook by thermal storage**



Do not use cookware with strong radiant heat



Do not load very heavy pots or pans or apply heavy loads

When using the stove, do not apply a load (total weight of cookware and food) to the pan support that will exceed 11lbs/5 kg. (Otherwise, deformations may cause unexpected accidents)



Do not surround the stove with a wind shield, splatter guard, stones, or other obstacles

These obstacles will cause the canister to absorb excessive heat. Never place a pot or other cookware on top of stove in this state, because it will become a cover. The heat will become excessive, and there is danger of an explosion.

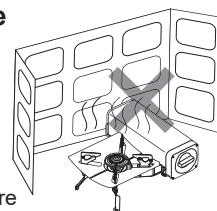

Do not use this product for purposes other than cooking

(Overheating, abnormal combustion, and other problems may cause burnout or fire)



Do not leave the product unattended while it is in operation

Stay near this product when it is on. Always make sure the flame has been extinguished before leaving the room or going to bed. In case of a phone call or visit, switch off the product.



Do not tilt or move the product while it is in operation

(If the product is tilted, it will cause burns or fires)



Do not use this product for drying clothes or as a heater

(Otherwise, falling clothes and other problems may cause a fire)

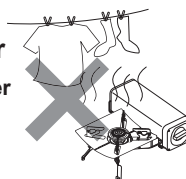

Do not allow children to use this product

Do not allow children to use this product and keep this product out of the reach of children.

Warning



Keep your head and hands away from the burner head

(Fire may cause an burns)



Ventilate during use

Pay careful attention to ventilation.



When the stove does not ignite on the first attempt, be careful of ignition

Before igniting the second time, make sure there is no smell of gas. The escaped gas may cause a fire. Wait at least 1 minute before retries.



After use, remove the canister

After use, always remove the canister from the main unit to prevent fire. If this product is stored with the canister still installed and something turns the ON/OFF knob, there is the potential of a gas leak or ignition, which is extremely dangerous.



While stove is in use, periodically check to see the flame is visible



Never modify or disassemble this product

(Disassembly could cause unexpected circumstances, such as death from carbon monoxide poisoning or a gas leak, failure, or fire)



During and for some time after use, do not touch other than the ON/OFF knob

(You may be burned if you touch other parts)



Carry out the following procedure during abnormalities or emergencies

Examples of abnormalities) Strange noises or smells, red flame, etc.

① Set the ON/OFF knob to the "OFF" position to extinguish the flame.

② Remove the canister from the main unit. (page 6)

③ Follow "Troubleshooting" (page 12).



Do not hold the handle and swing it or move it strongly

(Unexpected accidents may occur due to part damage or other problems)

Caution



If the stove falls or receives a strong impact, stop using it

Even if the exterior is not damaged, interior mechanisms may be damaged.

Even if the exterior is not damaged, please contact your place of purchase or our customer consultation center.

■ Handling the Canister

Instructions and warnings expressed on the canister should be read thoroughly. Before using, remove the canister cap. Before storing the canister, replace the canister cap.

Warning

Be sure to follow the instructions below to avoid the risk of fire or explosion.



Do not put the canister near a heat source

Do not put the canister in a place near a heat source. The pressure inside the canister may cause the canister to explode.



When storing the canister, avoid flames and direct sunlight

Keep the canister with canister cap fitted in a place under 104°F/40°C where it is airy and with little humidity. Keep away from flame and direct sunlight.



Do not throw the canister into a fire

Do not throw the canister into a fire. It will cause an explosion.



Proper disposal of canister

• Empty canister should be disposed of according to the rules and regulations of your city/town. Make sure can is completely empty before disposing of it.

• Shake the canister, if there is liquid still inside, please use it up before disposing.



Caution



Please use dedicated canister

Please use dedicated canister marked with "Iwatani Butane Fuel" or "FORE WINDS Butane Fuel". If other canisters are used, it may cause gas leak or abnormality of operation.



Inhalation risk

Do not intentionally suck gas from the canister, as this may lead to suffocation or death due to lack of oxygen.



Do not subject the canister to strong impacts

The canister may become damaged or ignite due to a gas leak if it suffers an impact from a falling object.



Do not use deformed canisters

(Doing so may lead to a gas leak)



Inspect stored canisters from time to time, always check that rusting canisters are free from gas leaks, and use them as soon as possible

*Even if a canister does not exhibit rusting, do not use a canister that has been stored for an extended period (more than 6 or 7 years as a rough guide).

Maintenance and inspection after use

■ Cautions during inspection and maintenance

Inspect and maintain the product after use.

- To protect your hands and fingers, always wear gloves.
- Do not wash this product as a whole.
If water enters the gas line, gas will no longer come out, which may cause rust.
- Always remove the canister before inspections and maintenance.
- Wait until the main unit has cooled down before inspecting and maintaining the product.
- Never disassemble the gas line section.
- If there is a spillover during use, please clean burner.

Inspection	Maintenance method	Precaution
Spillovers of food or liquid	Wipe off the spillover with a dry cloth. If the stain is obstinate, please use mild detergent. And wipe off totally with dry cloth.	Moisture and spillovers may cause malfunction, rust or failure. Please clean inside and outside frequently. Do not move electrode or flame rod.
If burner ports are blocked	Clean with a brush and/or small needle. (Do not move electrode or flame rod.)	It may cause incomplete ignition or irregular flames. Please clean burner frequently.
Food particles on electrode (burner won't ignite)	Please remove particles from electrode with dry cloth. (Do not move the electrode.)	If there is a stain on electrode, it may cause hindered ignition. During maintenance, if the ON/OFF knob rotates to "ON" position, it may cause electric shock.
Food residue on stove	Please wipe off with dry cloth. If the stain is set, use mild detergent with water and then dry.	Do not use thinner, gasoline, polishing powder, nylon brush or metal brush. This may cause damage to the machine.

■ When the product is not used for a long time

- Confirm there are no food particles causing blockage and the unit is dry.
- Separate the canister from the unit. Do not store when these two products are connected.
- When this product cools down, put into carrying case and store in a dry place. Never leave the unit outdoors without it being in the carrying case.
- Please perform regular inspection and maintenance to prevent product from rusting.
- Do not use any lubricants on this product.

■ Cautions regarding time-related deterioration of this product

Rubber parts are used in the gas connection opening of this product. Regardless of frequency of use, rubber parts deteriorate over time. Please consider replacing this product 10 years after manufacture.

- The manufacture date is listed on the rating plate.

Warranty and Repair

■ LIMITED WARRANTY INFORMATION

To view our limited warranty information, visit our website at www.iwatani.com/product-warranty, call us at 1-713-965-9970 or mail a written request including your name and return mailing address to:

Iwatani Corporation of America
ATTN: Product Warranty Request
2200 Post Oak Blvd., Suite 1150 Houston, TX 77056.

■ REPAIR (Out of Warranty)

Refer to the section "Troubleshooting" (page 12) and check the product again. If your product is malfunctioning, contact us through www.iwatani.com/contact or at 1-713-965-9970 with following information:

- Your name, address and daytime phone number
- Product name and model number (on the rating plate)
- Description of the problem (in as much detail as possible)

Troubleshooting

In the event of an unexpected malfunction, troubleshoot by using the following information.

Issue	Remedy	
	Cause	Solution
Canister cannot be installed → Remedy 1 2 3 4 11 12	1 Is there any deformation or warping on the main unit?	▶ Request an inspection and repair.
Difficult to ignite → Remedy 4 5 6 7 8 9	2 Have iron scraps or powder adhered to the magnet?	▶ Remove the iron scraps or powder using adhesive tape.
Cannot ignite → Remedy 5 6 7 8 9 10 11 12 13 15 16	3 Is the ON/OFF knob set to “ON”?	▶ Set the ON/OFF knob to “OFF”.
Burner would not stay lit → Remedy 5 7 10	4 Is a canister made by another company being used?	▶ Use a dedicated Iwatani canister.
Flames around the electrode is red → Remedy 17	5 Has the gas run out? Is there little gas remaining?	▶ Replace with a new canister.
Burns with a yellow flame → Remedy 7 10	6 Have stains or moisture stuck to the electrode section?	▶ Wipe away the stains or moisture.
Flame is unstable → Remedy 7 10	7 Is the burner flame opening clogged?	▶ Use a metal brush or other similar item to remove the clog.
Flame is irregular → Remedy 7	8 Is the ignition operation being performed correctly?	▶ Perform the ignition operation correctly. (page 6)
Heating power is low → Remedy 5 7 10 14	9 The ON/OFF knob may have failed.	▶ Request an inspection and repair.
There is a gas odor → Remedy 4 8 9 12	10 The gas duct (nozzle) may be clogged.	▶ Request an inspection and repair.
Flame goes out during use → Remedy 5 10 11	11 Has the pressure sensor safety device been activated?	▶ Reset the device following “● When the pressure sensor safety device has been activated” (page 3).
Flame does not go out → Remedy 9	12 Is the canister installed correctly?	▶ Install the canister correctly. (page 5)
Gas leaks even when the ON/OFF knob is “OFF” → Remedy 4 9 12	13 The ignition device may have failed.	▶ Request an inspection and repair.
A popping sound occurs during extinguishing → Remedy 18	14 Is the ON/OFF knob opened fully?	▶ Open the ON/OFF knob fully.
Flames burn away from the burner → Remedy 19	15 Is the spark jumping from the electrode to the burner?	▶ When the spark is not jumping from the electrode to the burner, adjust so that the distance between the electrode tip and burner is about 3 mm, and the flame opening is centered.
	16 Is the spark jumping?	▶ If the spark is not jumping, stains or water drops have stuck to the white section of the electrode (ceramic). Wipe away the stains or moisture.
	17 The flame around the electrode is red during the first use after purchase. After several uses, the red flame disappears. Continue to use the product as is.	
	18 A sound during extinguishing is not a problem. Continue to use the product as is.	
	19 This is not a problem. Turn down the ON/OFF knob slightly for 2 to 3 minutes.	